

宗 地 图

XDG-2019-38号地块

单位: m · m²

3485.00-40533.25,
3485.00-40533.50,
3485.25-40533.25

320292004104GB00029

北

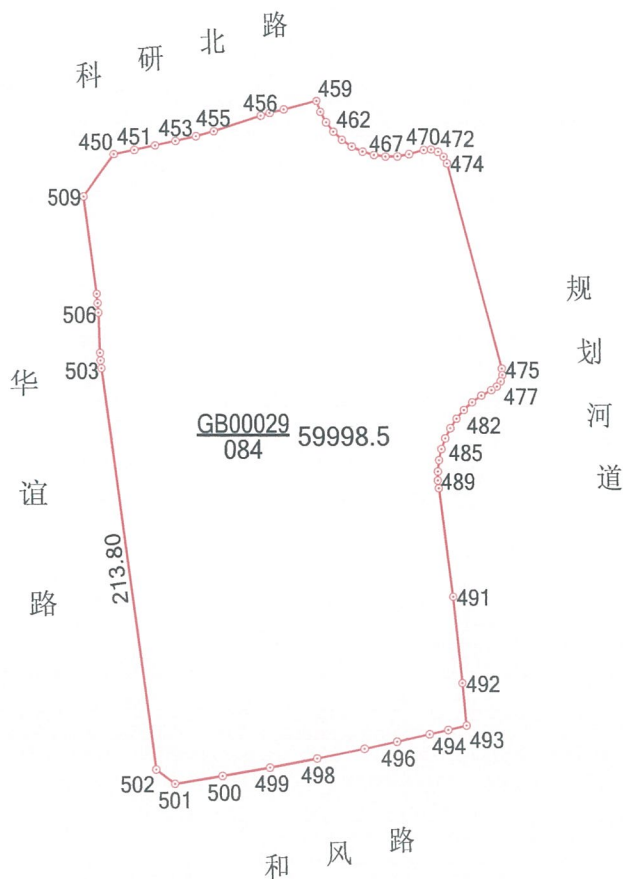

450-451: 11.17	451-452: 11.17	470-471: 3.92	471-472: 3.91	490-491: 57.77	491-492: 45.80
452-453: 11.17	453-454: 11.17	472-473: 3.91	473-474: 3.91	492-493: 22.54	493-494: 10.01
454-455: 9.75	455-456: 26.10	474-475: 112.01	475-476: 3.42	494-495: 10.02	495-496: 17.63
456-457: 4.96	457-458: 7.66	476-477: 3.42	477-478: 3.42	496-497: 17.63	497-498: 25.46
458-459: 17.95	459-460: 6.14	478-479: 3.42	479-480: 6.01	498-499: 25.45	499-500: 25.45
460-461: 6.26	461-462: 6.26	480-481: 6.01	481-482: 6.01	500-501: 25.46	501-502: 12.62
462-463: 6.26	463-464: 6.26	482-483: 6.01	483-484: 6.01	503-504: 4.09	504-505: 4.09
464-465: 6.26	465-466: 6.26	484-485: 6.01	485-486: 6.01	505-506: 21.21	506-507: 5.02
466-467: 6.26	467-468: 6.26	486-487: 6.01	487-488: 6.01	507-508: 4.98	508-509: 51.81
468-469: 6.26	469-470: 8.02	488-489: 4.68	489-490: 4.19	509-450: 27.46	

1:4000

绘图员: 吴景宇

审核员: 常鹏

2019年8月21日

界址点成果表

宗地号 320292004104GB00029

宗地面积 (平方米) 59998.5

界址点坐标

顺序号	点号	坐标		边长 (m)	备注
		X (m)	Y (m)		
1	450	3485424.959	40533340.221	11.17	
2	451	3485427.221	40533351.162	11.17	
3	452	3485429.544	40533362.090	11.17	
4	453	3485431.928	40533373.004	11.17	
5	454	3485434.372	40533383.905	9.75	
6	455	3485436.991	40533393.293	26.10	
7	456	3485445.220	40533418.057	4.96	
8	457	3485446.667	40533422.803	7.66	
9	458	3485448.496	40533430.239	17.95	
10	459	3485452.920	40533447.637	6.14	
11	460	3485447.131	40533449.678	6.26	
12	461	3485441.638	40533452.682	6.26	
13	462	3485436.676	40533456.502	6.26	
14	463	3485432.367	40533461.044	6.26	
15	464	3485428.815	40533466.200	6.26	
16	465	3485426.104	40533471.844	6.26	
17	466	3485424.302	40533477.840	6.26	
18	467	3485423.451	40533484.043	6.26	
19	468	3485423.572	40533490.303	6.26	
20	469	3485424.662	40533496.469	8.02	
21	470	3485426.883	40533504.171	3.92	

界址点成果表

宗地号 320292004104GB00029

宗地面积 (平方米) 59998.5

界址点坐标

顺序号	点号	坐标		边长 (m)	备注
		X (m)	Y (m)		
21	470	3485426.883	40533504.171	3.92	
22	471	3485427.144	40533508.078	3.91	
23	472	3485425.886	40533511.785	3.91	
24	473	3485423.302	40533514.724	3.91	
25	474	3485419.784	40533516.437	112.01	
26	475	3485311.491	40533545.052	3.42	
27	476	3485308.081	40533545.347	3.42	
28	477	3485304.788	40533544.435	3.42	
29	478	3485302.030	40533542.409	3.42	
30	479	3485300.164	40533539.540	6.01	
31	480	3485297.261	40533534.283	6.01	
32	481	3485293.745	40533529.413	6.01	
33	482	3485289.668	40533525.002	6.01	
34	483	3485285.090	40533521.114	6.01	
35	484	3485280.078	40533517.805	6.01	
36	485	3485274.703	40533515.125	6.01	
37	486	3485269.044	40533513.111	6.01	
38	487	3485263.184	40533511.793	6.01	
39	488	3485257.208	40533511.191	4.68	
40	489	3485252.529	40533511.123	4.19	
41	490	3485248.378	40533511.668	57.77	

界址点成果表

宗地号 320292004104GB00029

宗地面积 (平方米) 59998.5

界址点坐标

顺序号	点号	坐标		边长 (m)	备注
		X (m)	Y (m)		
41	490	3485248.378	40533511.668	57.77	
42	491	3485191.091	40533519.087	45.80	
43	492	3485145.544	40533523.850	22.54	
44	493	3485123.106	40533526.017	10.01	
45	494	3485120.792	40533516.274	10.02	
46	495	3485118.527	40533506.510	17.63	
47	496	3485114.661	40533489.313	17.63	
48	497	3485110.950	40533472.082	25.46	
49	498	3485105.865	40533447.139	25.45	
50	499	3485101.101	40533422.137	25.45	
51	500	3485096.660	40533397.074	25.46	
52	501	3485092.541	40533371.948	12.62	
53	502	3485100.115	40533361.858	213.80	
54	503	3485312.027	40533333.530	4.09	
55	504	3485316.091	40533333.081	4.09	
56	505	3485320.172	40533332.816	21.21	
57	506	3485341.362	40533331.994	5.02	
58	507	3485346.365	40533331.599	4.98	
59	508	3485351.324	40533331.120	51.81	
60	509	3485402.670	40533324.183	27.46	
61	450	3485424.959	40533340.221		